

Mounting parts

- 1 Butterfly valve (preferably in semiclosed position)
- 2 Mounting plate with 2 bolts and nuts
- 3 Handlever with screw, washer, plug and logo plate

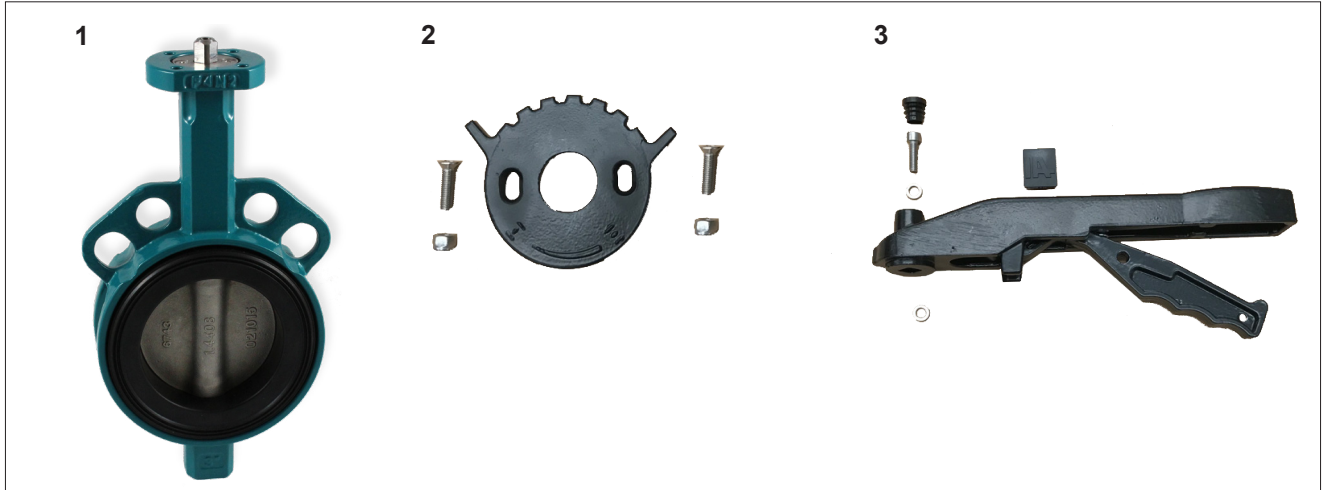

Mounting the handlever

- 4 Make sure valve is fixed and ready for hand lever assembly.
- 5 Place the mounting plate on the top flange of valve.
- 6 Place screws in the holes.
- 7 Place nuts on the screws without tightening.

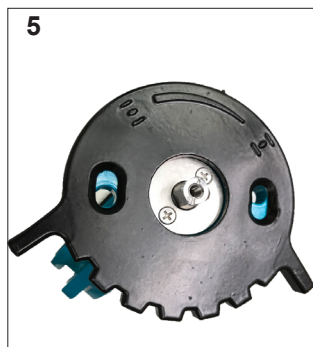

- 8 Place grover washer inside hand lever square and then place hand lever on shaft.
- 9 Place screw and washer on the upper part of the hand lever and tighten.
- 10 Move handlever until valve is in closed position.
- 11 Make sure lower part of hand lever is fixed on its position.

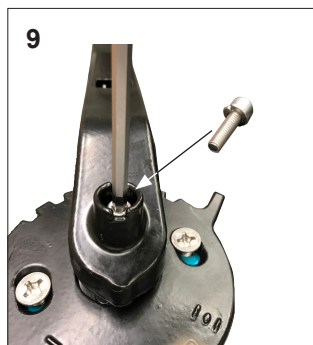

- 12 Adjust the mounting plate as it shows the closed position and tighten the screws. Screw on the back must be fastened first.
- 13 Move hand lever and fasten other screw.

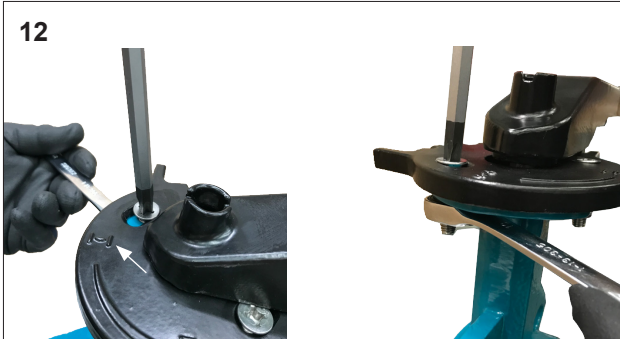

- 14 Bring hand lever to closed position.
- 15 Place cover and logo plate on hand lever.

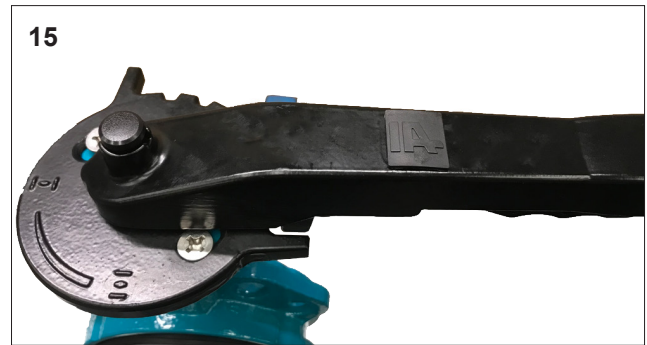

Note: To ensure correct locking, a specific padlock model has to be used. Please contact InterApp for the details about the padlock model.

Note
